

MAGNETIC BASE DRILL

MANUAL ARA-100A

TOP CLASS POWER & VERSATILITY

FEATURES

- Large diameter hole cutting
- Cuts 18mm - 100mm dia. through up to 75mm plate thickness
- Two speed electric drill with speed adjustment
- Load Indication and LED Condition System
- Drilling position adjustment 20mm back and forth and 15 degrees left or right
- Reversible feed handles
- Fitted with side-lock holder (TB09792 - MT03075) to use 75mm deep side-lock Jetbroach cutters from 50 - 100mm dia
- Can take Hibroach and Jetbroach cutters as well as 3 Morse Taper Twist Drill Bits up to 32mm
- Requires an industrial holder (TB09727) for use with Hibroach One-Touch cutters



KEY FEATURES



DIMENSIONS

ARA-100A
Unit : mm

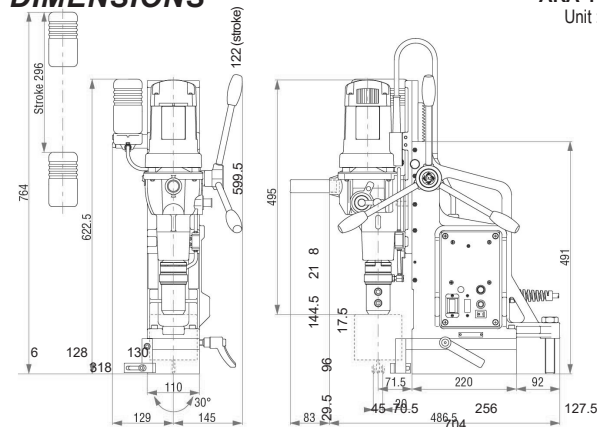

Position Adjustable - Loosen Lever Clamp

- Clamp can be positioned for left and right hand operation.



Twist Drill Bits - available on market

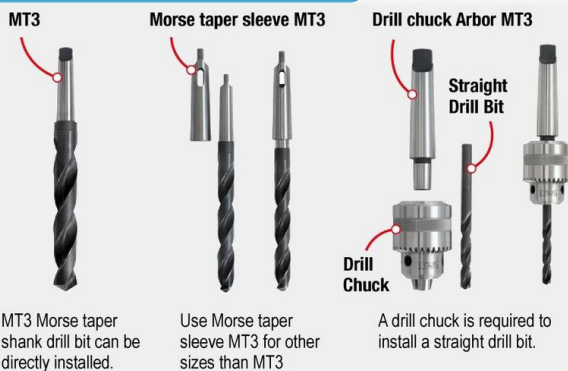

MT3 Morse taper shank drill bit can be directly installed.

Use Morse taper sleeve MT3 for other sizes than MT3

A drill chuck is required to install a straight drill bit.

Optional Items

- One-touch holder
Part No: TB09727



HIBROACH

- High Speed Steel One-Touch Type (25mm and 50mm depth of cut)



JETBROACH

- TCT Carbide Tipped Cutters (25mm, 35mm and 50mm depth of cut)



Always use Genuine Nitto Kohki Cutters

Model No.	Power Source	Rated Power Consumption	No Load Speed	Hole Diameter	Plate Thickness	Magnet Holding Power	Weight
ARA-100A	220~240V AC 50/60HZ	1,800W	Low 110-210rpm High 330-660 rpm	17.5 - 100mm	9 - 75mm	1,733 kg/f	30kg